

7311NA

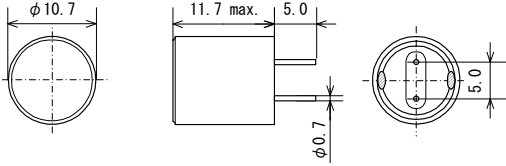

Frequency Range: ~1MHz
 Inductance Range: 10 ~ 1000 μ H
 Temperature Coefficient: +600 \pm 500ppm/ $^{\circ}$ C



Features

- Suitable for digital power amplifier
- Accomplished low total harmonics distortion as compared with our current type
- Possible to decrease reflection noise
- Available for high density mount due to compact size
- Best suited as a choke coil for power supply

7313NA



Frequency Range: ~1MHz
 Inductance Range: 10 ~ 1000 μ H
 Temperature Coefficient: +500 \pm 400ppm/ $^{\circ}$ C

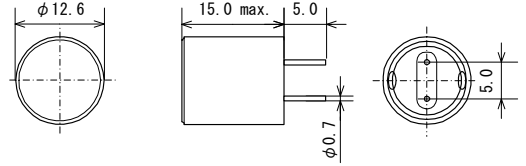

特長

- デジタルアンプ用インダクタに最適
- 従来品に比べ、全高調波歪を低減
- 輻射ノイズ低減
- 小型で高密度実装が可能
- 電源用のチョークコイルとしても最適

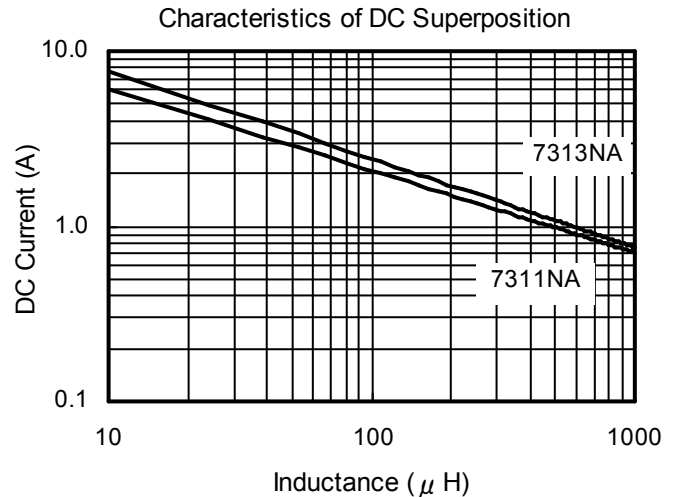
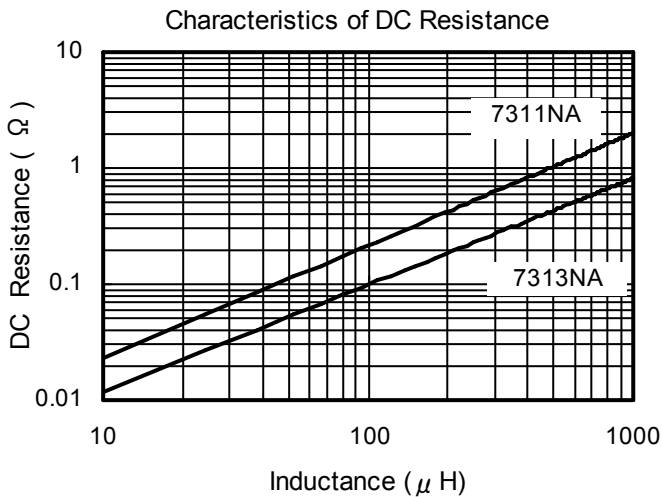

Notes: 1. Graphs are based on typical values of each type, not spec. values.
 2. DC current value is being measured at 10% decrease of inductance.

記事: 1. 特性グラフは各タイプの代表値を基に作成しています。規格値ではありません。
 2. 電流値はインダクタンスが10%低下する時の値です。

Coil Selection Guide

| Inductance インダクタンス | | DC Resistance 直流抵抗(Ω) max.- typical | | | | DC saturation allowable current 直流重畳許容電流 (A) | | Temperature rise allowable current 温度上昇許容電流 (A) | |
|-----------------------|------|---|-------|--------|-------|--|--------|---|--------|
| Code | (μH) | 7311NA | | 7313NA | | 7311NA | 7313NA | 7311NA | 7313NA |
| 100 | 10 | 0.032 | 0.025 | 0.015 | 0.012 | 5.5 | 6.0 | 3.3 | 5.1 |
| 120 | 12 | 0.036 | 0.028 | 0.017 | 0.013 | 4.6 | 5.4 | 3.1 | 5.0 |
| 150 | 15 | 0.048 | 0.037 | 0.021 | 0.016 | 4.1 | 4.7 | 2.7 | 4.6 |
| 180 | 18 | 0.057 | 0.044 | 0.024 | 0.018 | 3.8 | 4.2 | 2.5 | 4.3 |
| 220 | 22 | 0.066 | 0.051 | 0.028 | 0.022 | 3.4 | 4.0 | 2.3 | 3.9 |
| 270 | 27 | 0.095 | 0.073 | 0.036 | 0.028 | 3.0 | 3.4 | 1.9 | 3.4 |
| 330 | 33 | 0.100 | 0.077 | 0.044 | 0.034 | 2.7 | 3.0 | 1.85 | 3.1 |
| 390 | 39 | 0.115 | 0.088 | 0.059 | 0.045 | 2.5 | 2.8 | 1.75 | 2.6 |
| 470 | 47 | 0.120 | 0.092 | 0.071 | 0.055 | 2.3 | 2.6 | 1.70 | 2.4 |
| 560 | 56 | 0.135 | 0.104 | 0.083 | 0.064 | 2.2 | 2.5 | 1.60 | 2.2 |
| 680 | 68 | 0.180 | 0.138 | 0.115 | 0.088 | 1.9 | 2.2 | 1.40 | 1.9 |
| 820 | 82 | 0.215 | 0.165 | 0.120 | 0.092 | 1.7 | 2.1 | 1.25 | 1.8 |
| 101 | 100 | 0.245 | 0.19 | 0.135 | 0.10 | 1.6 | 1.8 | 1.20 | 1.7 |
| 121 | 120 | 0.260 | 0.20 | 0.155 | 0.12 | 1.4 | 1.6 | 1.15 | 1.6 |
| 151 | 150 | 0.300 | 0.23 | 0.170 | 0.13 | 1.3 | 1.5 | 1.10 | 1.5 |
| 181 | 180 | 0.450 | 0.35 | 0.190 | 0.15 | 1.2 | 1.4 | 0.90 | 1.4 |
| 221 | 220 | 0.495 | 0.38 | 0.215 | 0.17 | 1.1 | 1.2 | 0.85 | 1.3 |
| 271 | 270 | 0.65 | 0.50 | 0.280 | 0.22 | 0.95 | 1.1 | 0.75 | 1.2 |
| 331 | 330 | 0.94 | 0.72 | 0.340 | 0.26 | 0.85 | 1.0 | 0.62 | 1.1 |
| 391 | 390 | 1.00 | 0.77 | 0.440 | 0.34 | 0.80 | 0.9 | 0.59 | 0.95 |
| 471 | 470 | 1.15 | 0.88 | 0.535 | 0.41 | 0.75 | 0.8 | 0.56 | 0.90 |
| 561 | 560 | 1.55 | 1.19 | 0.665 | 0.51 | 0.70 | 0.75 | 0.48 | 0.80 |
| 681 | 680 | 1.75 | 1.35 | 0.840 | 0.65 | 0.60 | 0.70 | 0.45 | 0.75 |
| 821 | 820 | 2.65 | 2.04 | 0.935 | 0.72 | 0.55 | 0.60 | 0.37 | 0.70 |
| 102 | 1000 | 2.90 | 2.23 | 1.050 | 0.81 | 0.50 | 0.55 | 0.35 | 0.65 |

Notes: 1. Measurement Frequency for Inductance: 1kHz

2. DC saturation allowable current: Value of inductance decrease within 10%.
3. Temperature rise allowable current: A rise in temperature of core surface is within 40°C.

記事: 1. インダクタンス測定周波数: 1kHz

2. 直流重畳許容電流: インダクタンスの減少が10%以内の電流値。
3. 温度上昇許容電流: コアの表面温度上昇が40°C以下の電流値。

Inductance range インダクタンス範囲

| Tolerance | 7311NA | 7313NA |
|-----------|-------------|--------|
| ±20%(M) | 10~39 μH | |
| ±15%(L) | 47~82 μH | |
| ±10%(K) | 100~1000 μH | |

Parts Code 品番コード例

| | | | |
|--------|---|-----|---|
| 7311NA | - | 101 | K |
|--------|---|-----|---|

Type Inductance Code Tolerance
タイプ インダクタンスコード 許容差