

4-1 電源電流ダイオード

V _{RM} (V)	I _F (AV) (A) ()フィン付	パッケージ Axial (ボディ径/リード径)	品名	I _{FSM} (A)	T _j ()	T _{stg} ()	V _F (V) max	I _F (A)	I _R (μA)	I _R (H) (μA)	T _a ()	R _{th} (j-l) R _{th} (j-c) (/W)	質量 (g)
				50Hz 正弦半波単発					V _R =V _{RM} max	V _R =V _{RM} max			
1000	0.8	Axial(4.0/ 0.78)	RM 1C	40	40 ~ +150		1.2	1.0	5	50	100	15	0.4
	1.0	Axial(2.7/ 0.78)	EM 1C	35	40 ~ +150		0.97	1.0	20	100	100	17	0.3
	1.2	Axial(4.0/ 0.98)	RO 2C	80	40 ~ +150		0.92	1.5	10	50	100	12	0.61
	1.2	Axial(4.0/ 0.78)	RM 11C	100	40 ~ +150		0.92	1.5	10	50	100	15	0.4
	1.2	Axial(4.0/ 0.98)	RM 2C	100	40 ~ +150		0.91	1.5	10	50	100	12	0.6
	2.0	Axial(5.2/ 1.2)	RM 3C	150	40 ~ +150		0.95	2.5	10	100	150	10	1.0
	1.7(3.0)	Axial(6.5/ 1.4)	RM 4C	150	40 ~ +150		0.95	3.0	10	50	100	8	1.2

ブリッジ

V _{RM} (V)	I _F (AV) (A) ()フィン付	パッケージ	品名	I _{FSM} (A)	T _j ()	T _{stg} ()	V _F (V) max	I _F (A)	I _R (μA)	I _R (H) (μA)	T _a ()	R _{th} (j-l) R _{th} (j-c) (/W)	質量 (g)
				50Hz 正弦半波単発					V _R =V _{RM} max	V _R =V _{RM} max			
60	4.0	RBV-40	RBV-406B ^{*1}	40	40 ~ +150		0.62	2.0	2	55	150	5	4.25
100	4.0	RBV-40	RBV-401	80	40 ~ +150		1.05	2.0	10	100	100	5.0	4.05
	6.0	RBV-60	RBV-601	120	40 ~ +150		1.00	3.0	10	100	100	3.0	6.45
200	4.0	RBV-40	RBV-402	80	40 ~ +150		1.05	2.0	10	100	100	5.0	4.05
	4.0	RBV-40	RBV-402L ^{*2}	80	40 ~ +150		0.98	2.0	50	100	100	5.0	4.05
	6.0	RBV-60	RBV-602L ^{*3}	100	40 ~ +150		1.0	3.0	250	1000	100	3.0	6.45
	6.0	RBV-60	RBV-602	120	40 ~ +150		1.00	3.0	10	100	100	3.0	6.45
	10	RBV-40	RBV-4102	80	40 ~ +150		1.1	5.0	10	100	150(T _j)	2.0	4.05
400	4.0	RBV-40	RBV-404	80	40 ~ +150		1.10	2.0	10	100	100	5.0	4.05
	6.0	RBV-60	RBV-604	120	40 ~ +150		1.05	3.0	10	100	100	3.0	6.45
600	4.0	RBV-40	RBV-406	80	40 ~ +150		1.10	2.0	10	100	100	5.0	4.05
	4.0	RBV-40	RBV-406H	120	40 ~ +150		0.92	2.0	10	100	100	5.0	4.05
	4.0	RBV-40	RBV-406M	120	40 ~ +150		1.00	2.0	10	100	100	5.0	4.05
	6.0	RBV-60	RBV-606	120	40 ~ +150		1.05	3.0	10	100	100	3.0	6.45
	6.0	RBV-60	RBV-606H	140	40 ~ +150		1.05	3.0	10	200	100	3.0	6.45
	10	RBV-40	RBV-4106M	120	40 ~ +150		1.00	5.0	10	100	100	2.0	4.05
	13	RBV-60	RBV-1306	80	40 ~ +150		1.20	6.5	10	100	100	1.5	6.45
	15	RBV-60	RBV-1506S	150	40 ~ +150		1.10	7.5	10	200	100	1.5	6.45
	15	RBV-60	RBV-1506J	150	40 ~ +150		1.10	7.5	10	200	150(T _j)	1.5	6.45
	15	RBV-60	RBV-1506	200	40 ~ +150		1.05	7.5	50	200	100	1.5	6.45
800	25	RBV-60	RBV-2506	350	40 ~ +150		1.05	12.5	50	200	100	1.5	6.45
	4.0	RBV-40	RBV-408	100	40 ~ +150		1.00	2.0	10	50	100	5.0	4.05
	6.0	RBV-60	RBV-608	170	40 ~ +150		0.95	3.0	10	100	100	3.0	6.45
1000	4.0	RBV-40	RBV-40C	100	40 ~ +150		1.00	2.0	10	50	100	5.0	4.05
	15	RBV-60	RBV-150C	200	40 ~ +150		1.05	7.5	50	200	100(T _j)	1.5	6.45

* 1 : ショットキバリアダイオード

* 2 : 超高速整流ダイオード (trr=40ns)

* 3 : 超高速整流ダイオード (trr=50ns)

・ No. 13 Axial (2.7/ 0.6)

シリコンバリスタ (対称型)

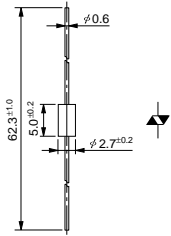

・ No. 14 Axial (2.7/ 0.78)

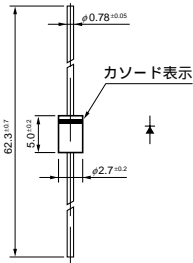

・ No. 15 Axial (4.0/ 0.78)

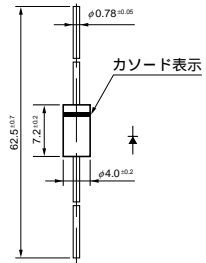

・ No. 16 Axial (4.0/ 0.98)

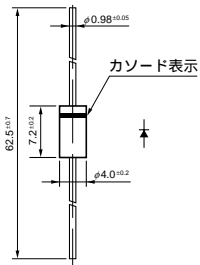

・ No. 17 Axial (5.2/ 1.2)

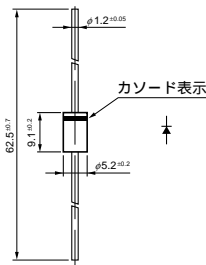

・ No. 18 Axial (6.5/ 1.4)

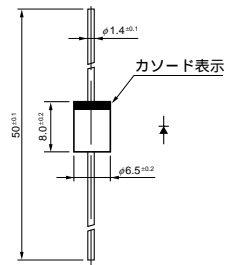

・ No. 19 Axial (10.0/ 1.3)

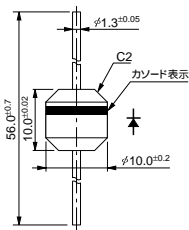

・ No. 20 TO-220F (2 素子)

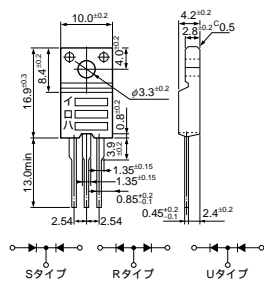

イ . 品名
ロ . 極性
ハ . ロット番号

・ No. 21 TO-220F (Center-tap)

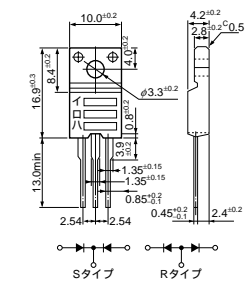

イ . 品名
ロ . 極性
ハ . ロット番号

・ No. 22 TO-220F2Pin

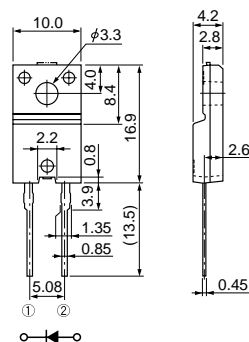

・ No. 23 TO-220F2Pin (2 素子)

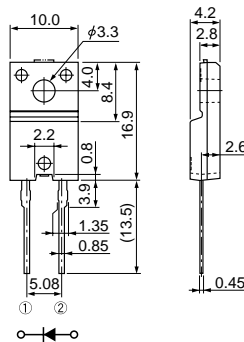

・ No. 24 TO3PF

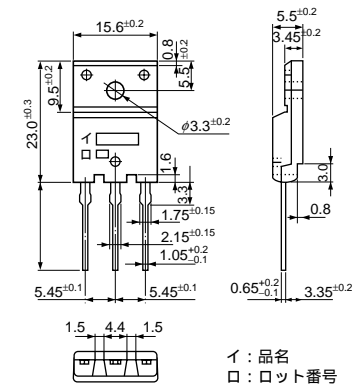

イ : 品名
ロ : ロット番号

特性図 電源整流ダイオード

SFPM-5シリーズ

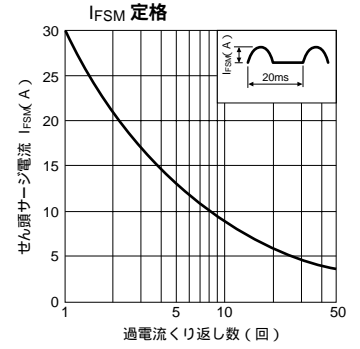
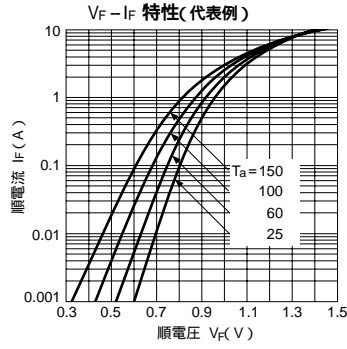
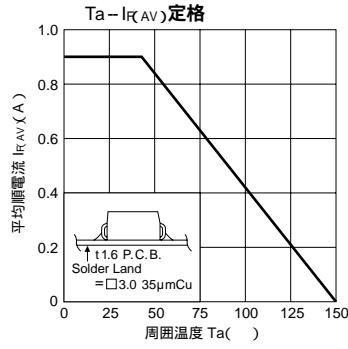

SFPM-6シリーズ

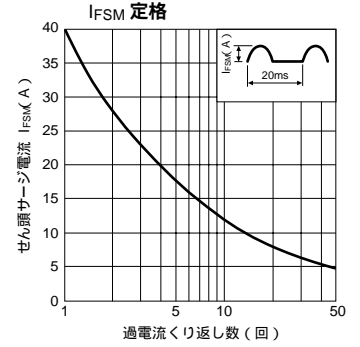
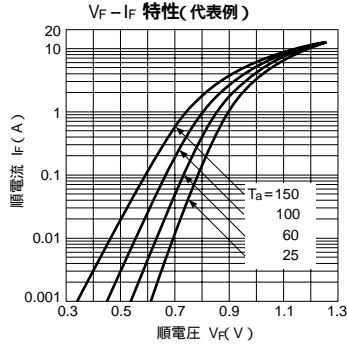
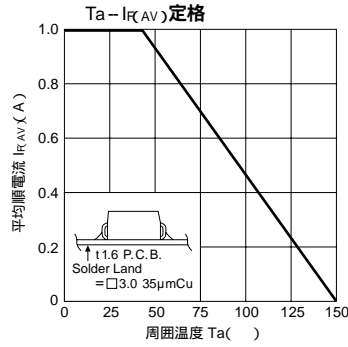

AM01シリーズ

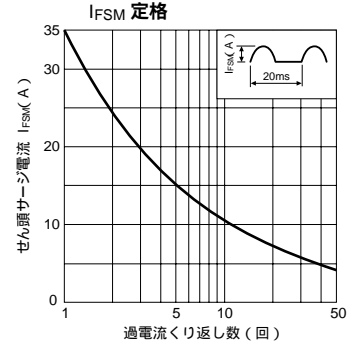
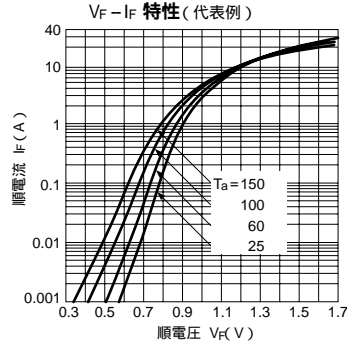
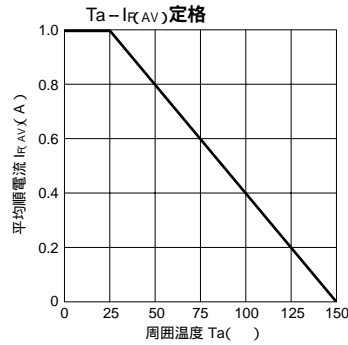

EM01シリーズ

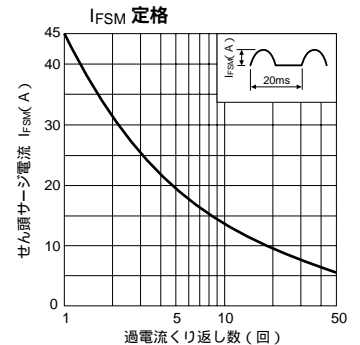
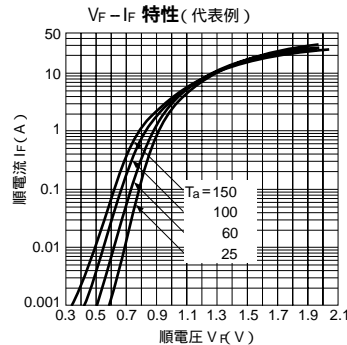
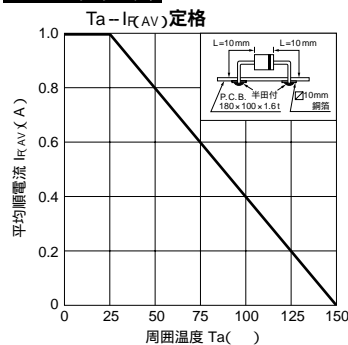

EM 1シリーズ

