

# 8Y

## Mustang Pushbutton Switches

RoHS Compliant



### Features

The 8Y series is a sub-miniature pushbutton switch with a larger, rugged actuator and a larger bushing. Suitable for applications where panel space is limited and a larger actuator is needed.

### Table of Part Numbers

Terminal style	No. of pole		1 pole	2 poles	3 poles	4 poles
	Switching function					
S/D	ON	— ON	8Y1011—Z	8Y2011—Z	8Y3011—Z	★ 8Y4011—Z
	ON	— (ON)	8Y1021—Z	☆ 8Y2021—Z ▲ 8Y2021C—Z	★ 8Y3021—Z	★ 8Y4021—Z

### Panel Cut-Out Dimensions

Panel thickness : 5 mm max.

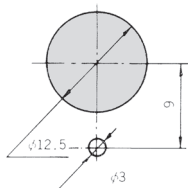

With Locking Ring

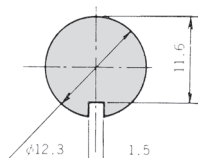

Without Locking Ring

### Terminal Styles

Solder (Style:1)

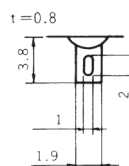

### Standard Accessories

《Supplied with switch》

Hex Nut	Lockwasher	Locking Ring
140008010243	140008030055	140008020067
Nickel plated	Zinc plated	Zinc plated

### Optional Accessories

《Sold separately》

Color Cap		
Dimensions	Color	Part No.
	White	140000470023
	Red	140000470052
	Black	140000470051
	Gray	140000470057

● Specify the Color Cap by part number if Color Cap is desired.

### Color Cap Mounting

Snap in the color button on to the actuator.

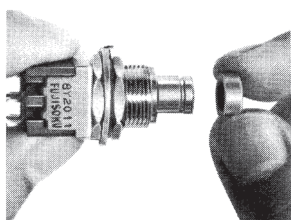

Optional Accessories.

★ : Made to order products.

☆ : Semi-standard products.

(ON) : Momentary.

▲ : Inquiry products.

## SPDT

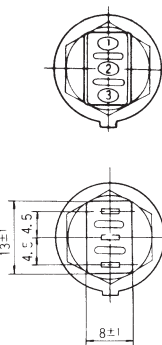
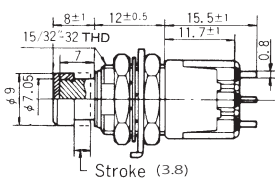
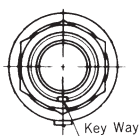
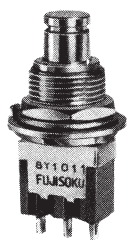

Switching function		
Part No.		
※ 8Y1011-Z	ON	ON
8Y1021-Z	ON	(ON)
Connecting terminals	2-3	2-1

S/D

Terminal numbers are not shown on the switch.

## DPDT

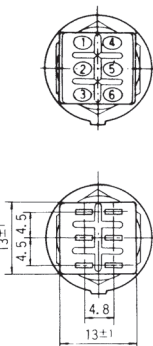
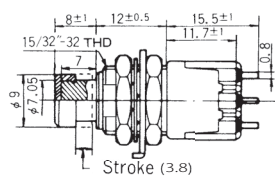
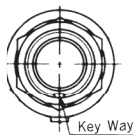

Switching function		
Part No.		
※ 8Y2011-Z	ON	ON
☆ 8Y2021-Z	ON	(ON)
Connecting terminals	2-3 5-6	2-1 5-4

S/D

Terminal numbers are not shown on the switch.

## 3PDT

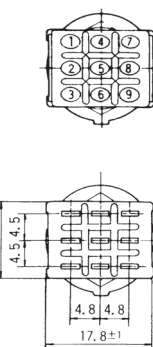
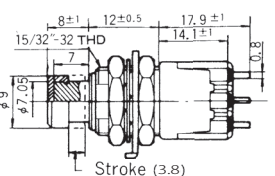
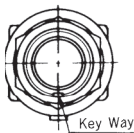

Switching function		
Part No.		
※ 8Y3011-Z	ON	ON
★ 8Y3021-Z	ON	(ON)
Connecting terminals	2-3 5-6 8-9	2-1 5-4 8-7

S/D

Terminal numbers are not shown on the switch.

## 4PDT

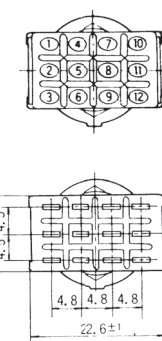
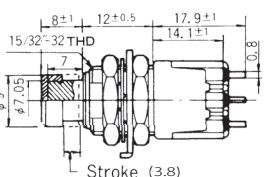
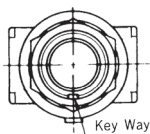

Switching function		
Part No.		
★※ 8Y4011-Z	ON	ON
★ 8Y4021-Z	ON	(ON)
Connecting terminals	2-3 5-6 8-9 11-12	2-1 5-4 8-7 11-10

S/D

Terminal numbers are not shown on the switch.

## ■ Panel Cut-Out Dimensions

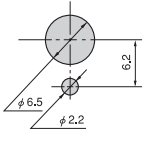
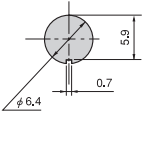
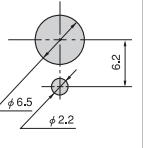
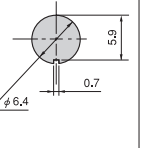
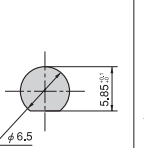
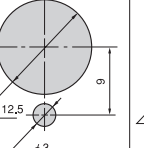
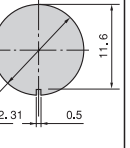
Series	8N		8R		8P	8Y	
Panel thickness	1.5 mm Max.	2.5 mm Max.	2 mm Max.	3 mm Max.	4.5 mm Max.	5 mm Max.	6 mm Max.
Dimensions							
	With Locking Ring	Without Locking Ring	With Locking Ring	Without Locking Ring		With Locking Ring	Without Locking Ring

## ■ PC Hole Layouts

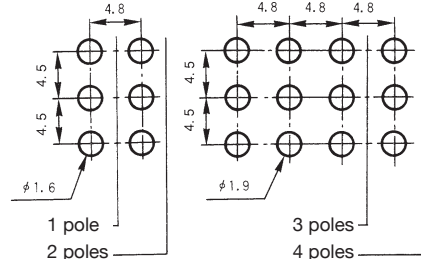
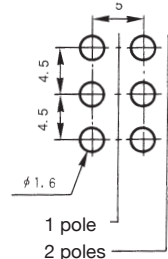
Series	8N · 8P	8R · 8W
Dimensions	 <p>1 pole 2 poles 3 poles 4 poles</p>	 <p>1 pole 2 poles</p>

## ■ Precautions (8N·8P·8R·8W·8Y)

### 1. Soldering Specifications

#### (1) Manual soldering

Device : Solder iron

① 420°C Max. 3 sec. Max.

#### (2) Auto soldering

② The above-stated soldering conditions shall apply only to switches with straight terminals. Auto soldering is not possible with right-angle terminals. Switches with right-angle terminals should be soldered manually according to the conditions specified in (1) above.

(3) When putting the switches through an aging process after they were soldered onto the printing board or after installed into a complete end product, be sure to remove the buttons of the switches.,

### 2. Mounting

- Do not bend the terminals before mounting the switch on the PC board.
- After mounting the switch, do not place the device in such a way that the device weight will be applied on to the actuator of the switch.
- For switches with straight terminals, solder the switch on the PC board after fixing the switch on the panel with a nut.

### 3. Flux Cleaning

- (1) Solvent : Fluorine or Alcohol type.
- (2) 8A/B/C/D/E/F/J/S series are not washable. To wash the PC board, clean the soldering surface of the PC board with a brush so that the switch is not exposed to the cleaning solution.

## ■ Packaging Specification

