

REV.	REVISIONS	DATE
------	-----------	------

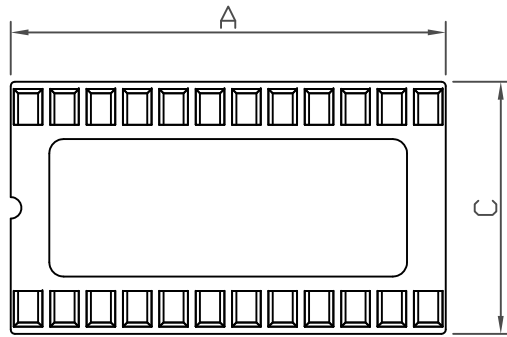

Insulator Material:PBT &30% Glass Fiber(UL 94V-0)

Contact Resistance:30MΩ at DC 100MA

Insulator Resistance:1000MΩ Min atDC 250V

Current Rating:1 AMP

Dielectric Withstanding Voltage:AC 500V For 1minute

Temperature Rating: -40℃ ~ +85℃

Contract Material:Phospher Bronze

Plating:Tin plated.

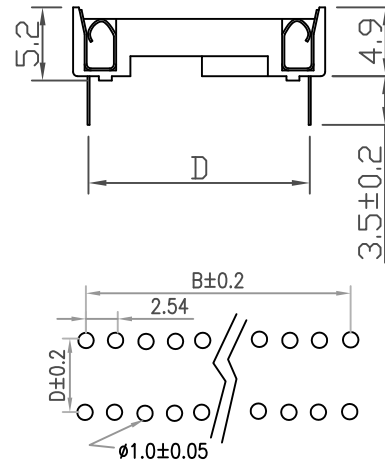
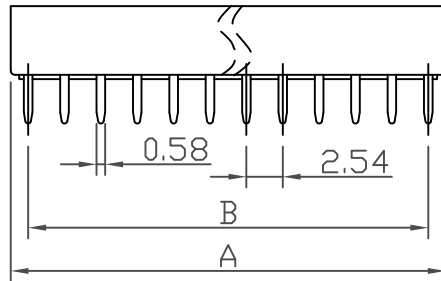

P.C. Board Layout

NO. OF PINS	DIMENSIONS: (UNIT:mm±0.2)			
	A	B	C	D
6	7.62	5.08	9.96	7.62
8	10.16	7.62		
14	17.78	15.24		
16	20.32	17.78		
18	22.86	20.32		
20	25.40	22.86		
24	30.48	27.94		
28	35.56	33.02		
 				
24	30.48	27.94	17.60	15.24
28	35.56	33.02		
32	40.64	38.10		
40	50.80	48.26		
42	53.34	50.80		

Order Code

2 1 2 0 - x x

No of contacts

x

x

x

E

RoHS

TYPE:

N: Space 7.62

B: Space 15.24 / W Bar

W: Space 15.24 / W/O Bar

SCALE:		UNIT: MM	2120 XX NE SERIES	
TOLERANCE:				
		.X ±0.15		
		.XX ±0.3		
APP	James	18-09-15	TITLE: IC SOCKET 2.54mm RoHS	
CHK	Huang	01-05-13		REV. X3
DRW	Arthur	12-12-00	DWG NO.2120-001	SIZE A4
			SHT 1 OF 1	