

| | 5 | 6 | 7 | | |
|-----------|------------------|------------------|------------------|------------------|------------------|
| | A | B | C | D | E |
| Positions | ±0.25 (0.010) | ±0.13 (0.005) | ±0.38 (0.015) | ±0.25 (0.010) | ±0.25 (0.010) |
| 09 | 16.92 0.666 | 24.99 0.984 | 30.81 1.213 | 19.28 0.759 | 16.33 0.643 |
| 15 | 25.25 0.994 | 33.32 1.312 | 39.14 1.541 | 27.65 1.089 | 24.66 0.971 |
| 25 | 38.96 1.534 | 47.04 1.852 | 53.04 2.088 | 41.30 1.626 | 38.38 1.511 |
| 37 | 55.42 2.182 | 63.50 2.500 | 69.32 2.729 | 57.44 2.261 | 54.84 2.159 |

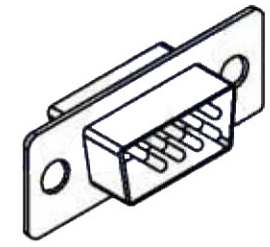

SPECIFICATIONS

- Insulator : PBT+30% glass fiber , UL 94V-0
- Contact : Brass or Phosphor bronze
- Current rating (Max) : 5 amp AC / DC
- Withstanding voltage : 1000 VAC
- Insulation resistance (Min.):1000M Ω
- Contact resistance (Max):30M Ω
- Operating temperature : -55°C~+105°C