

| | | | | | | |
|---|---|---|---|---|---|---|
| A | B | C | D | E | F | G |
| 1 | 2 | 3 | 4 | 5 | 6 | 8 |
| A | B | C | D | E | F | G |
| 1 | 2 | 3 | 4 | 5 | 6 | 8 |

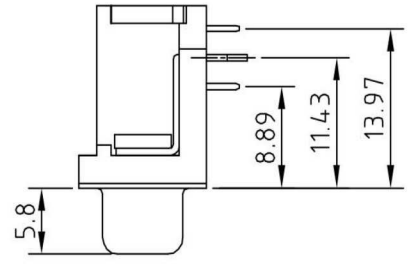
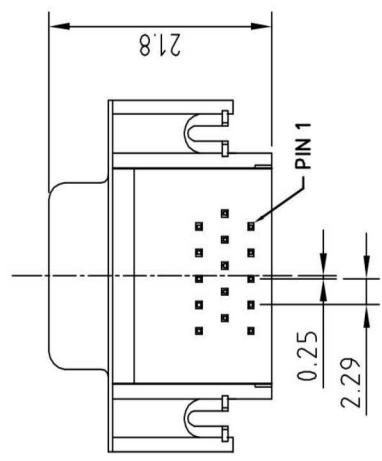
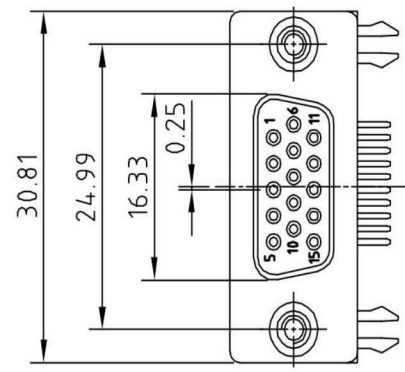

PN: C0562-15FBAXXXR

ELECTRICAL CHARACTERISTICS

Contact Current Rating: 3Amperes.
 Dielectric Withstanding Voltage: AC 500V at sea level.
 Insulation Resistance: 1000Megohms Min.
 Contact Resistance: 25Milliohms Max.
 Operation Temperature : -55°C to +105°C.

Material
 Contact : Copper Alloy.
 Insulator: PBT.
 Shell: SPCC.
 Z-Piece: SPCC
 Screw: Copper Alloy.
 Rivet: Copper Alloy. or Zinc.

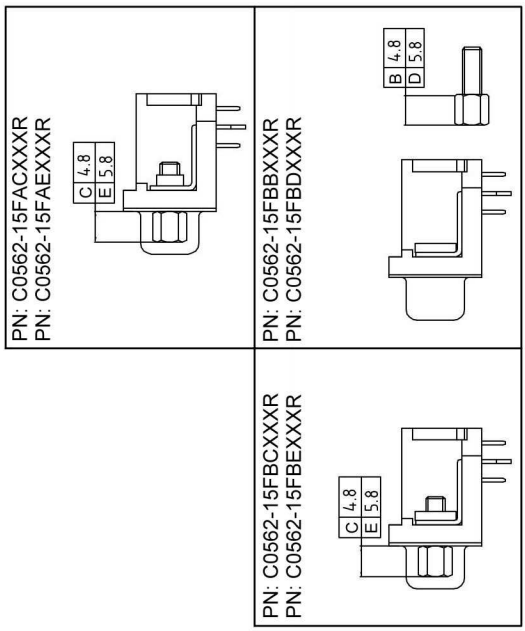

RECOMMEND P.C.B. LAYOUT

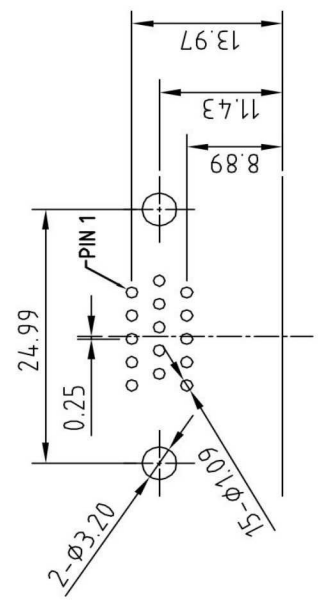

RoHS Compliant

APPD. 核准: HELEN
 DWG. 製圖: ABBY
 DATE 制表日: 2015/11/30

SCALE 比例: 參考
 UNIT 單位: MM
 PAGE 張數: 1 OF 1

TOLERANCE 容許公差:
 X: ±0.30
 XX: ±0.25
 XXX: ±0.15
 A: 0.125
 SIZE 紙張尺寸: A 4
 REV. 版次: B

PART NAME 品名: HIGH DENSITY D-SUB PCB
 RIGHT ANGLE STAMPED PIN
 15P FEMALE ROHS
 PART NO. 料號: C0562-15FXXXXXR