

# Datasheet

## 14 W IDC Side Socket

RS Stock number [642-4963](#)

### Drawing (mm):

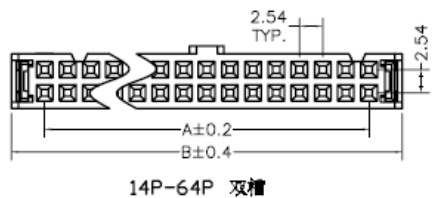
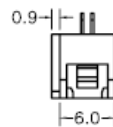
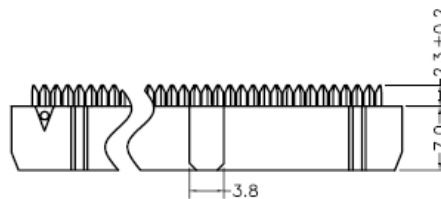
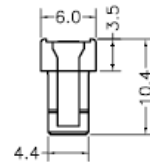
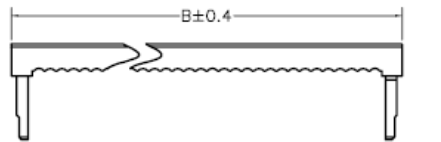
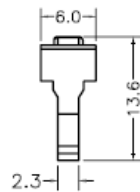
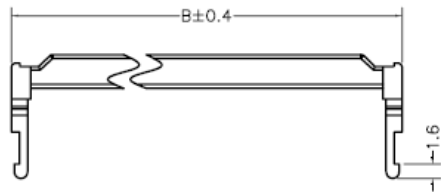

14P-64P 双槽



一般型端子

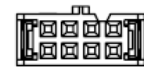
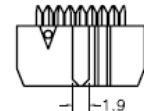
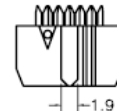

6P 小鼻/单槽

8P 小鼻/单槽

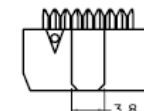
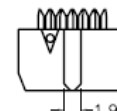

6P 小鼻/无槽

8P 大鼻/无槽

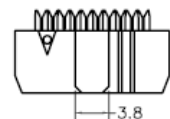

10P-12P 单槽

### Product Specification

#### Material

Insulator :Glass-Filled Thermoplastic  
PBT, UL94V-0 rates

Contact : Copper alloy

Plated full gold or selected gold in mating area, 100u" min. tin-lead on termination area, with entire contact under-plated 50u" min. Nickel

#### Electrical

Contact Resistance :20 milliohms

Insulation Resistance :5000 magohms at 500 VDC

Dielectric Withstanding Voltage : 500 VAC/rms 60Hz for 1 minute

Current Rating :1 AMP

Volatge Rating :250 VAC/rms 60Hz