

SHELL SIZE

16

## PLT Series

Input Type

PLT®

SINCE 1978

C<sub>UL</sub>® TÜV APEX CONNECTOR

## INPUT TYPE

IP67

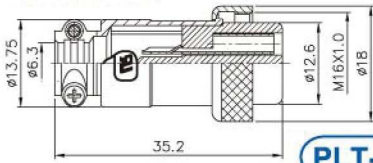

PLT-16-P-R

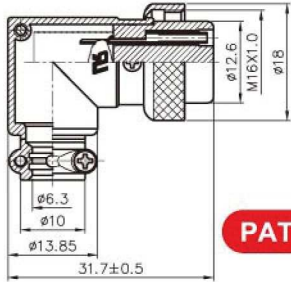

PAT PLT-16-LP-R

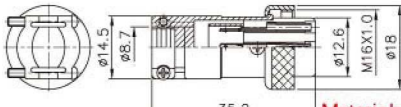

PLT-16-PA-R

Material: Zinc Alloy  
材質: 鋅合金

PLT-16-RCaC-R

PLT-16-RCa-R

Material: Brass  
材質: 銅Material: Brass  
材質: 銅

U-C5

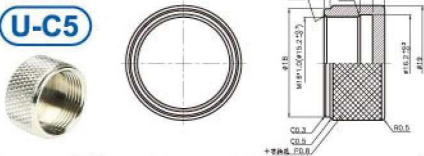

Stainless Steel 不銹鋼材質



PLT-16 Series

PIN	2	3	4	5	6	7	8
L	20.5	20.5	20.5	20.5	19	19	19

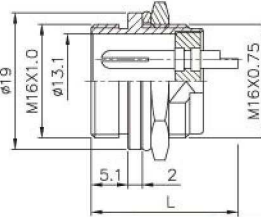

PAT PLT-16-R-R

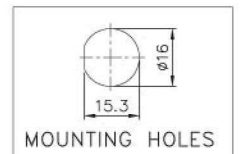
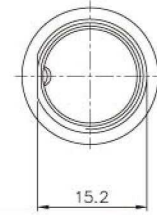

MOUNTING HOLES

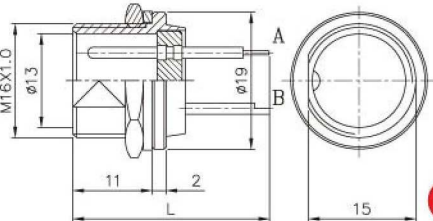
\*A: PCB TYPE  
\*B: SOLDERING TYPE

PAT PLT-16-RL-R

FORM 1 FOR PLT-16*-RL						
LENGTH	L1	L2	L3	L4	L5	L6
SIZE	20.5	23.5	29	30.5	21.5	21.5

\*FORM 2 (ACCESSORIES)

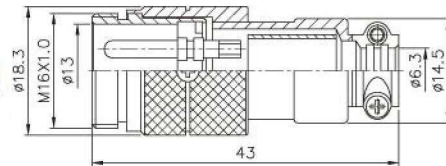
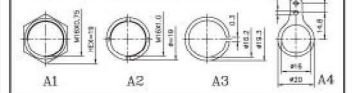

PLT-16-AD-R

PD:98441

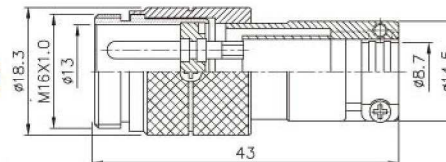

PLT-16-ADA-R

(Patent of invention, all rights reserved 專利產品、仿冒必究)

◆ No. of contacts	2	3	4	5	6	7	8		
Contacts Configuration									
	TÜV	TÜV	TÜV	TÜV	TÜV	TÜV	TÜV		
Rated current / voltage	5A 125V	5A 125V	5A 125V	5A 125V	5A 125V	5A 125V	5A 125V		
Operation limit voltage (AC.V.rms)	200	200	200	200	200	200	200		
Withstanding voltage (AC.V.rms) 1 minute	1000	1000	1000	1000	1000	1000	1000		
Insulation resistance (MΩ MIN.) at DC 500V	1000	1000	1000	1000	1000	1000	1000		
Contact resistance (mΩ MAX.) at DC 1A	3	3	3	3	3	3	3		
Solder inter diameter	1.4	1.4	1.4	1.2	0.8	0.8	0.8		