

# Subminiature Rotary Coded Switches

## Specifications:

Contact rating:	50 V DC, 100 mA, non switching 15 V DC, 30 mA, switching
Contact resistance:	< 100 mΩ
Insulation resistance:	> 1000 MΩ at 250 V DC
Dielectric strength:	250 V, 50 Hz for the duration of 1 minute
Operating temperature:	- 25° to + 75° C
Mechanical life:	minimum 20 000 operations
Contacts:	gold-plated
Terminals:	PC terminals, phosphor bronze, tin-plated
Case material:	PBT black, rotor: standard types yellow; inverse types red
Construction:	case totally sealed, suitable for washing by immersion
Mounting:	on pc-board
Soldering conditions:	auto-soldering – max.: 3 sec, 245° C ± 10° C

## Models:

Models:	Code				
DRS 3010	BCD				
DRS 3110	BCD Inverse				
DRS 3016	Hexadecimal				
DRS 3116	Hexadecimal Inverse				
DRS 4010	BCD				
DRS 4110	BCD Inverse				
DRS 4016	Hexadecimal				
DRS 4116	Hexadecimal Inverse				
DRR 3010	BCD				
DRR 3110	BCD Inverse				
DRR 3016	Hexadecimal				
DRR 3116	Hexadecimal Inverse				
DRR 4010	BCD				
DRR 4110	BCD Inverse				
DRR 4016	Hexadecimal				
DRR 4116	Hexadecimal Inverse				

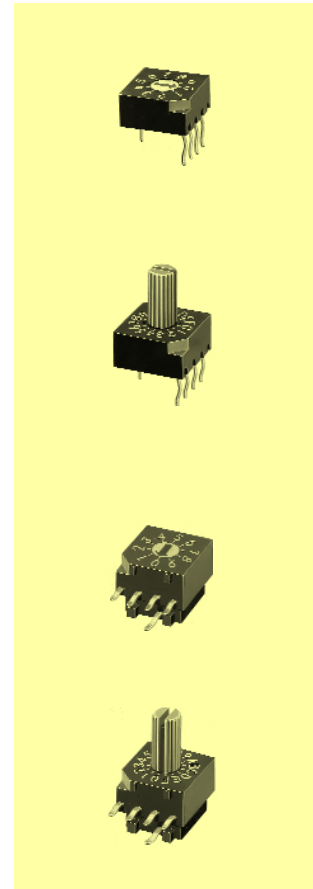

## Accessories:

### Caps\*

yellow	KR 108
red	KR 109
white	KR 110

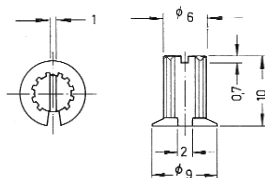

grey KR 207

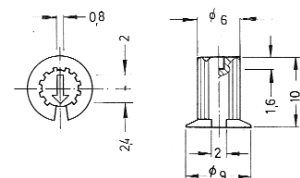

\* further types on request

# Subminiature Rotary Coded Switches for SMT

## Specifications:

Contact rating:	50 V DC, 100 mA, non switching 15 V DC, 30 mA, switching
Contact resistance:	< 100 mΩ
Insulation resistance:	> 1000 MΩ at 250 V DC
Dielectric strength:	250 V, 50 Hz for the duration of 1 minute
Operating temperature:	- 20° to + 80° C
Mechanical life:	minimum 20 000 operations
Contacts:	phosphor bronze, gold-plated
Terminals:	phosphor bronze, tin-plated
Case material:	PPS black, rotor: standard types yellow; inverse types red
Construction:	case totally sealed with protective tape
Mounting:	on pc-board – SMD

<b>Models:</b>	Code
SMR 5010	BCD
SMR 5110	BCD Inverse

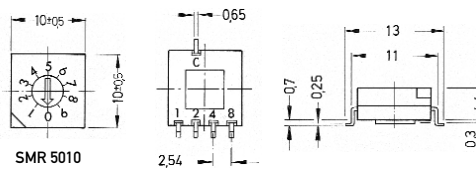

SMR 5016	Hexadecimal
SMR 5116	Hexadecimal Inverse

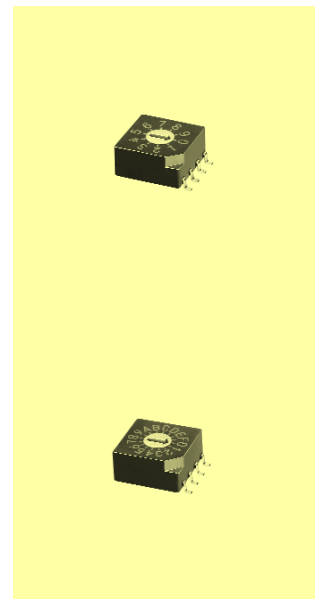
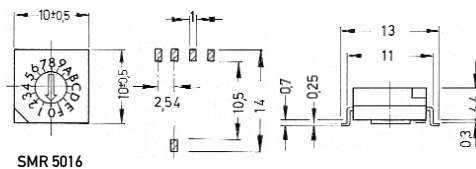

Soldering conditions: reflow-line – max.: 40 sec, 200° C  
peak temperature: 230° C

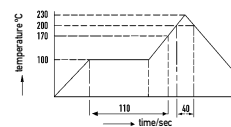

Packaging: sticks or tapes  
for order on tape: additional to type number: T  
example of order: SMR 5010 T

Stick	Tape	Reel
50 pieces; L 530 mm	500 pieces	Ø 330 mm

