

PUW-20

A detailed view of the internal mechanism of a mechanical device, showing a black plastic housing with various metal components including springs, levers, and a central shaft.

- Ultra up Mechanism (screw up type) is employed. The screw does not come off at connection.
- The terminal blocks come in compact design (terminal pitch : 8mm)
- Each terminal block can be installed on the DIN rail by a single action and also can be removed even in the middle of the rail.

- Standard service conditions : Ambient temperature -25℃ to +60℃
Relative humidity 45 to 85%
- Temperature rise :35degrees or less at conductive plate
- Insulation resistance :200MΩ or more between live parts and between each
live part and metal plate
(Measured with DC 500V megger)
- Power-frequency withstand voltage : 2500V for 1 minute
- Applicable standard : JIS C2811

PUW-20

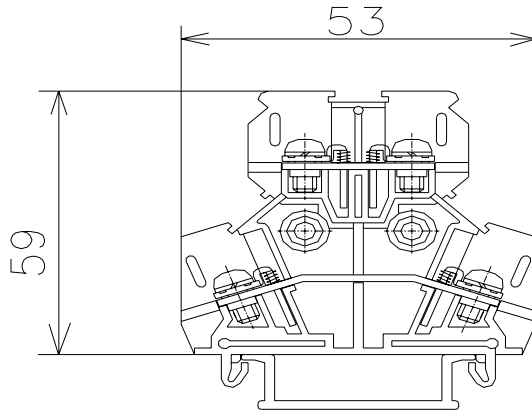
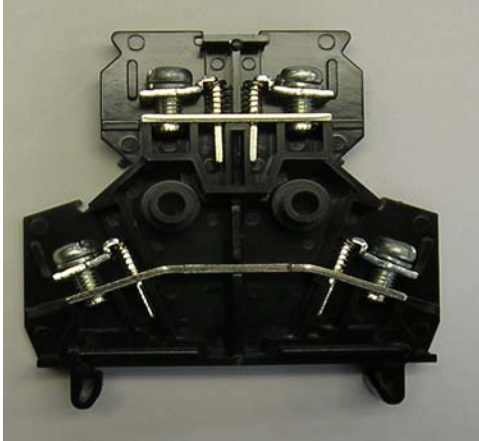

Rating Voltage	AC/DC600V
Rating Current	22A
Connectable wire	2.0mm ²
Max Current	1.25mm ² -16A
	2.0mm ² -22A
Terminal screw	M3.5 × 7.3L
Tightening Torque	1.4N.m

End Plate (PPO)	PUW-20L
Name Plate (PVC)	M-1LE
Cover (PC)	CA-30
Short Bar (Jumper)	BB8 ,SB8
Stopper (SPCC)	HDV-2
Rail	DIN 35mm

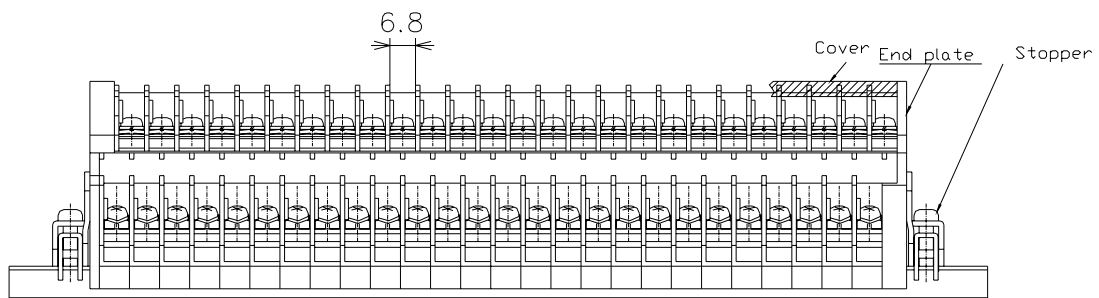

CTW 15S2

Use with DIN 35mm Rail

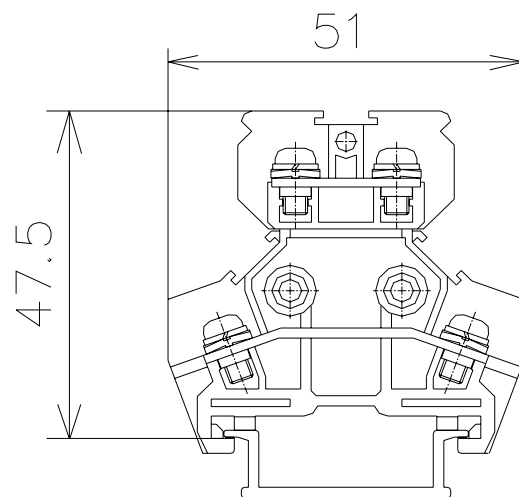

The CTW terminal blocks of a compact design (terminal pitch : 8mm) can have the required terminal block space inside your panels. These terminal blocks are suited for use in operation panels, control panels and instrumentation panels, especially for use in sequencer mounting panels.

In addition, wiring can be started from the upper or lower stage, whichever required, since the positions of terminals are different by half a pitch between the upper and the lower stage. Also when the lower stage is wired later, connection can be performed more smoothly thanks to the proper inclination of the terminals on the lower stage.

Rating Voltage	AC/DC600V
Rating Current	15A
Connectable wire	2.0mm ²
Max Current	1.25mm ² –15A
	2.0mm ² –15A
Terminal screw	M3.5 × 8L
Tightening Torque	1.4N.m

End Plate (PPO)	CTW-15L2
Name Plate (PVC)	M-1LE
Cover (PC)	CA-30
Short Bar (Jumper)	BB8 ,SB8
Stopper (SPCC)	HDV-2
Rail	DIN 35mm

PTW-SS Series

Use with DIN 35mm Rail

Support Screw Incorporated

- Unlike the conventional UP screw, the support screw (patent P) is held on the conductive plate even after it is loosened. Therefore, you have only to tighten up the screw when connecting a Y type solder less terminal. This type consisting of a smaller number of parts comes at a **lower cost** and will **improve your operation efficiency considerably**.
- The support screw can be set in a temporarily held position when connecting a ring solder less terminal.
- The support screw type is available in one stage or two stages. The terminal blocks can be easily removed even in the middle of the rail.

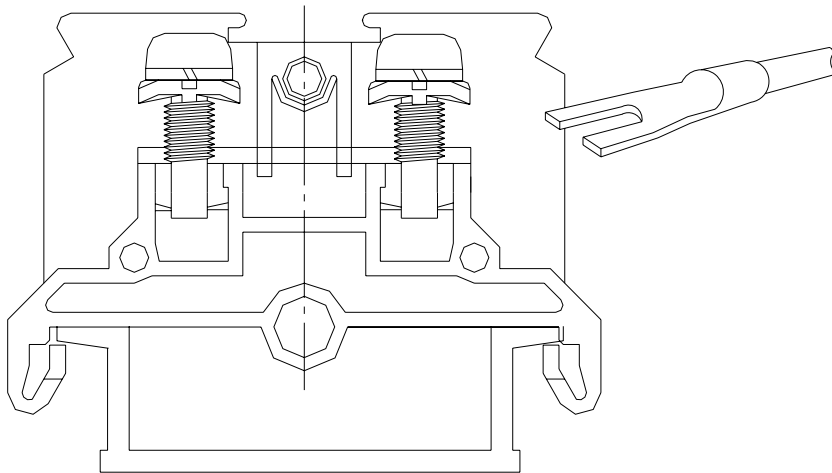

PTW-SS10

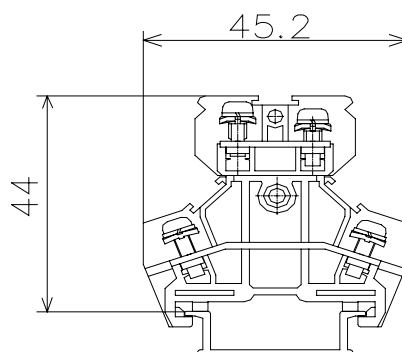
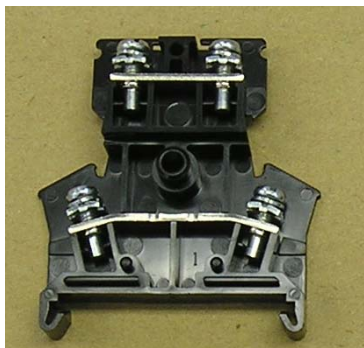

Rating Voltage	AC/DC600V
Rating Current	15A
Connectable wire	1.25mm ²
Max Current	0.75mm ² -11A
	1.25mm ² -15A
Terminal screw	M3 × 9.8L
Tightening Torque	1.2N.m

End Plate (PPO)	PSWL-1
Name Plate (PVC)	M-1LE
Cover (PC)	CA-28
Short Bar (Jumper)	BB7 ,SB7
Stopper (SPCC)	HDV-2
Rail	DIN 35mm

PTW-SS20

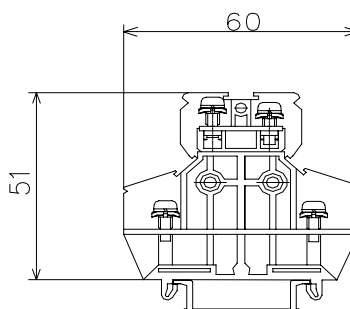
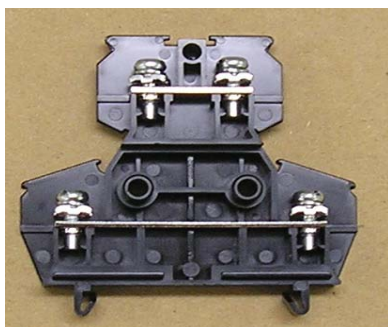

Rating Voltage	AC/DC600V
Rating Current	20A
Connectable wire	2mm ²
Max Current	1.25mm ² -16A
	2mm ² -20A
Terminal screw	M3.5 × 9.8L
Tightening Torque	1.4N.m

End Plate (PPO)	PSW-SS20L
Name Plate (PVC)	M-1LE
Cover (PC)	CA-30
Short Bar (Jumper)	BB8A ,SB8A
Stopper (SPCC)	HDV-2
Rail	DIN 35mm