

Part No.	Cable color
~088*1~	GRAY
~088*2~	BLACK
~088*3~	WHITE

NOTE ① We indicate the length of the harness on the last of product name. 'L' part.

② Tolerance for [L]

Length L [mm]	Tolerance [mm]
$35 \leq L \leq 200$	± 4
$200 < L \leq 500$	± 8
$500 < L \leq 1000$	± 12
$1000 < L$	$\pm 1.5\%$

③ Connector rotation angle is within ± 45 degree from the above image. For long length in the case of $L > 500$, the angle is optional.

4. Specifications are subject to change without notice.

【 DIMENSIONS OF CONNECTOR 】

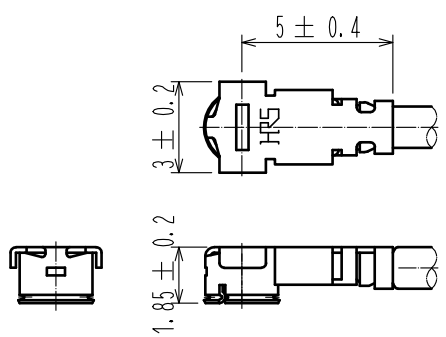

1	U. FL-LP-088	CL331-0454-0	2	1.37 Dia. coaxial cable
NO.	PART NO.	CODE NO.	NO.	PART NO.

UNITS mm	SCALE FREE	COUNT	DESCRIPTION OF REVISIONS	DESIGNED	CHECKED	DATE
HIROSE ELECTRIC CO., LTD.	APPROVED	•NK. NINOMIYA	16. 07. 22	DRAWING NO.		
	CHECKED	•MT. KANEKO	16. 07. 21	PART NO.		
	DESIGNED	•MS. MATSUMOTO	16. 07. 21	U. FL-2LP-088**T-A-L		
	DRAWN	•MS. MATSUMOTO	16. 07. 21	CODE NO.		